



## How will I find my way around the school?

- On your timetable you will find details of your subject, your teacher and which classroom to go to e.g.

**11:15 - 11:55**

History  
7  
U. O'Connor

- All the classrooms are on ground level, each classroom has a number on the door.
- The Canteen is at the centre of the school building – from here you turn right or left to find your classroom.
- Rooms 1 – 17 are to your left, rooms 18 to 27 are to your right.



Study the classroom map and answer the questions.....

1. Where can you find Room 5?
2. What subject do you study R20?
3. What is the number on the door for the Home Economics Room?
4. Which room is opposite the Staff Room?
5. Where are the girls and boys toilets located?
6. Where do you go if you are studying Woodwork?

# FIRE ESCAPE PLAN

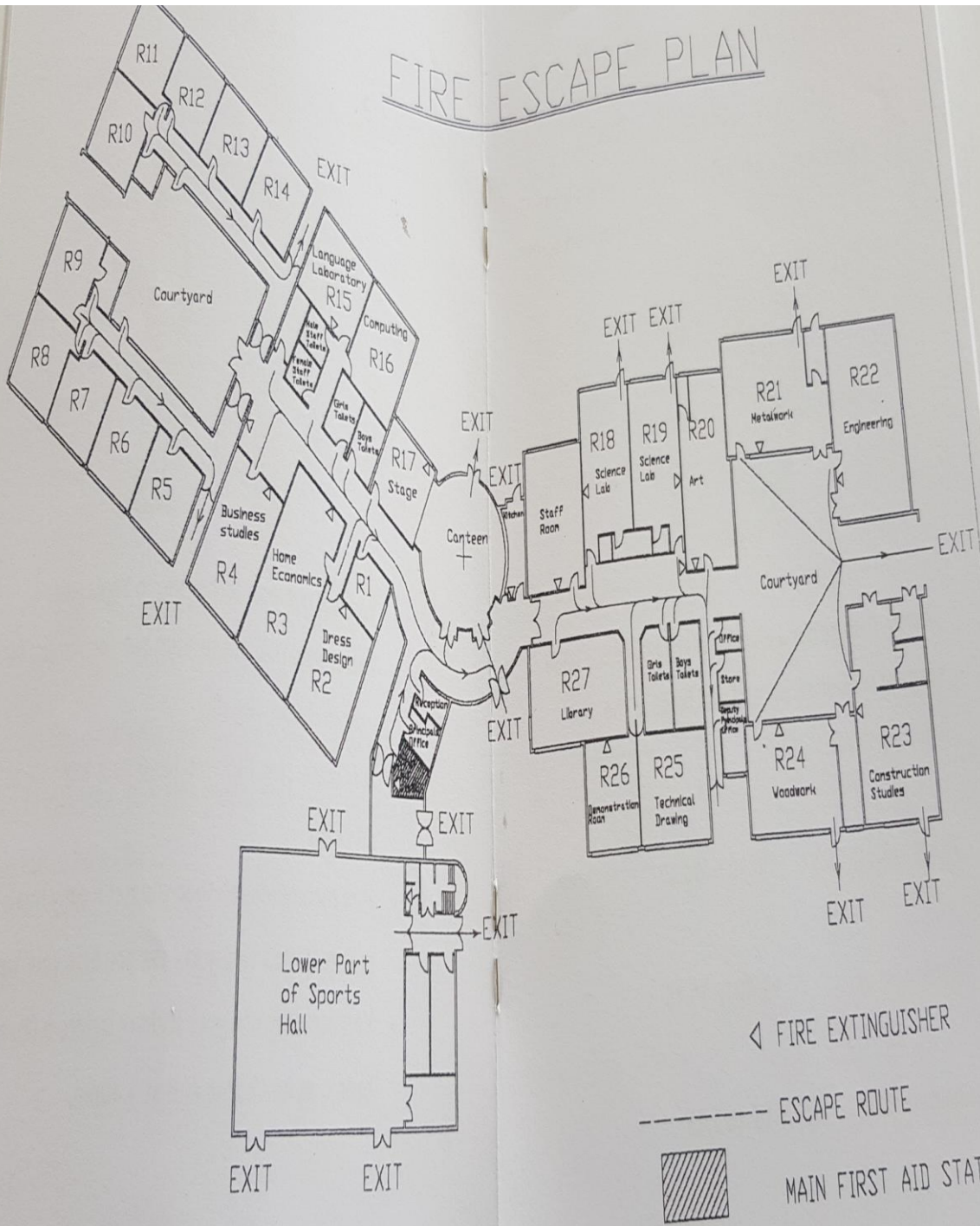

◁ FIRE EXTINGUISHER

--- ESCAPE ROUTE

▨ MAIN FIRST AID STATION